

RR

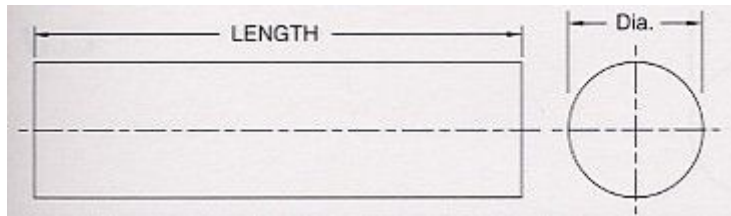

DIMENSIONS

Order No. Grade Stocked C-2 10% Micrograin

Rod Dia. & Length	Dia. (mm)	Length (mm)	RR
1/64 x 12.8	.40	325	RR-1
.025 x 12.8	.65	325	RR-1-1/2
1/32 x 12.8	.8	325	RR-2
.04 x 12.8	1.00	325	RR-2-1/2
3/64 x 12.8	1.20	325	RR-3
1/16 x 12.8	1.60	325	RR-4
5/64 x 12.8	2.00	325	RR-5
3/32 x 12.8	2.40	325	RR-6
7/64 x 12.8	2.75	325	RR-7
.118 x 12.8	3.00	325	RR-7-1/2
1/8 x 12.8	3.20	325	RR-8
9/64 x 12.8	3.50	325	RR-9
5/32 x 12.8	4.00	325	RR-10
11/64 x 12.8	4.30	325	RR-11
3/16 x 12.8	4.75	325	RR-12
.196 x 12.375	5.00	314	RR-12-1/2
13/64 x 12.375	5.20	314	RR-13
7/32 x 12.375	5.00	314	RR-14
15/64 x 12.375	6.00	314	RR-15
1/4 x 12.375	6.40	314	RR-16
17/64 x 12.375	6.75	314	RR-17
9/32 x 12.375	7.10	314	RR-18
19/64 x 12.375	7.50	314	RR-19
5/16 x 12.375	8.00	314	RR-20
21/64 x 12.375	8.40	314	RR-21
11/32 x 12.375	8.75	314	RR-22
23/64 x 12.375	9.10	314	RR-23
3/8 x 12.375	9.50	314	RR-24
25/64 x 12.375	10.00	314	RR-25
13/32 x 12.375	10.30	314	RR-26

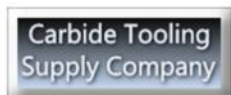

Main: 248-693-9202

Fax: 248-693-9210

contact@carbide Toolingsupply.com

27/64 x 12.375	10.71	314	RR-27
7/16 x 12.375	11.10	314	RR-28
29/64 x 12.375	11.51	314	RR-29
15/32 x 12.375	12.00	314	RR-30
31/64 x 12.375	12.30	314	RR-31
1/2 x 12.375	12.70	314	RR-32
17/32 x 12.375	13.50	314	RR-34
9/16 x 12.375	14.30	314	RR-36
5/8 x 12.375	15.90	314	RR-40
11/16 x 12.375	17.50	314	RR-44
3/4 x 12.375	19.00	314	RR-48
13/16 x 12.375	20.60	314	RR-52
7/8 x 12.375	22.20	314	RR-56
15/16 x 12.375	23.70	314	RR-60
1 x 12.375	25.50	314	RR-64
1-1/4 x 12.375	31.70	314	RR-80
1-1/2 x 12.375	38.10	314	RR-96

Special grades can be quoted.

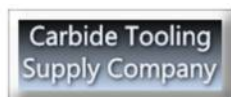

Main: 248-693-9202

Fax: 248-693-9210

contact@carbide Tooling Supply Company.com